



---

DESSAU Constructions GmbH

---

Version 1.00



# Capabilities & Real-World Applications

[www.dessau.ch](http://www.dessau.ch)



# Table of contents

---

Multi Profile Framer	01
Real-World Applications	02
Info	03

---

---

Chapter

Contents:

Profiles & Frames

---

Advanced Multi-Profile Framing System

I

---

Manufacturing Solution Up To 2.5mm (12ga)

II

---

# 1

# Multi Profile Framer.

# Advanced Multi-Profile Framing System

Our Multi-Profile Framing System is the core of our production, equipped with 16 hydraulic station bays and 16 pre-installed tool stations. This advanced system enables highly versatile manufacturing, supporting 8 standard profiles, with the flexibility to expand as needed.

Designed for heavy-duty framing, the machine ensures precision, efficiency, and reliability in every project. It features an automated profile web size adjustment, controlled by a software-driven servo system, allowing seamless adaptation to project-specific requirements while maintaining optimal performance.



# Manufacturing Solution Up To 2.5mm (12ga)

## Multi Profile Framer.

Our factory-based manufacturing process ensures high precision and efficiency, utilizing 8 selected profile tool sets for fast, reliable, and scalable cold-rolled Light Gauge Steel (LGS) frame production. The system is designed to handle steel thicknesses of up to 2.5mm (12 gauge), delivering consistent quality and structural accuracy for a wide range of applications.

With advanced automation and precision tooling, our production setup minimizes material waste while maximizing speed and reliability, making it ideal for high-volume manufacturing demands

---

**Profile shapes**

C & U

---

**Profile Tools**

8 Profile Web Sizes from 63mm to 300mm

---

**Sheet Thickness**

0.75 - 2.5 mm

---

**Manufacturing Speed**

200 - 700 m/h (Single machine)

---

**Hydraulic Pump**

22 kW

---

**Power Supply**

3 x 400V- 50 Hz, maximum 62 kW

---

---

Chapter

Contents:

Profiles & Frames

---

Residential Buildings

I

---

Industrial Buildings

II

---

Modular Buildings

III

---

Site Units

IV

---

Building Process in Photos

V

---

2

Real-World  
Applications.

# Residential Buildings

LGS allows for energy-efficient, lightweight structures that are quick to assemble and require less labor. It is ideal for custom-built homes with open layouts and large windows due to its high strength-to-weight ratio.



# Residential Buildings

## Multi-Story

With precise factory production, LGS ensures consistent quality across multiple units, reducing on-site errors. It also lowers foundation requirements, making it cost-effective for multi-story buildings while maintaining excellent fire, moisture, and seismic resistance.





# Industrial Buildings

LGS supports large, open spaces with minimal internal columns, maximizing storage capacity and allowing for efficient racking systems. Steel's corrosion resistance ensures longevity in harsh industrial environments.

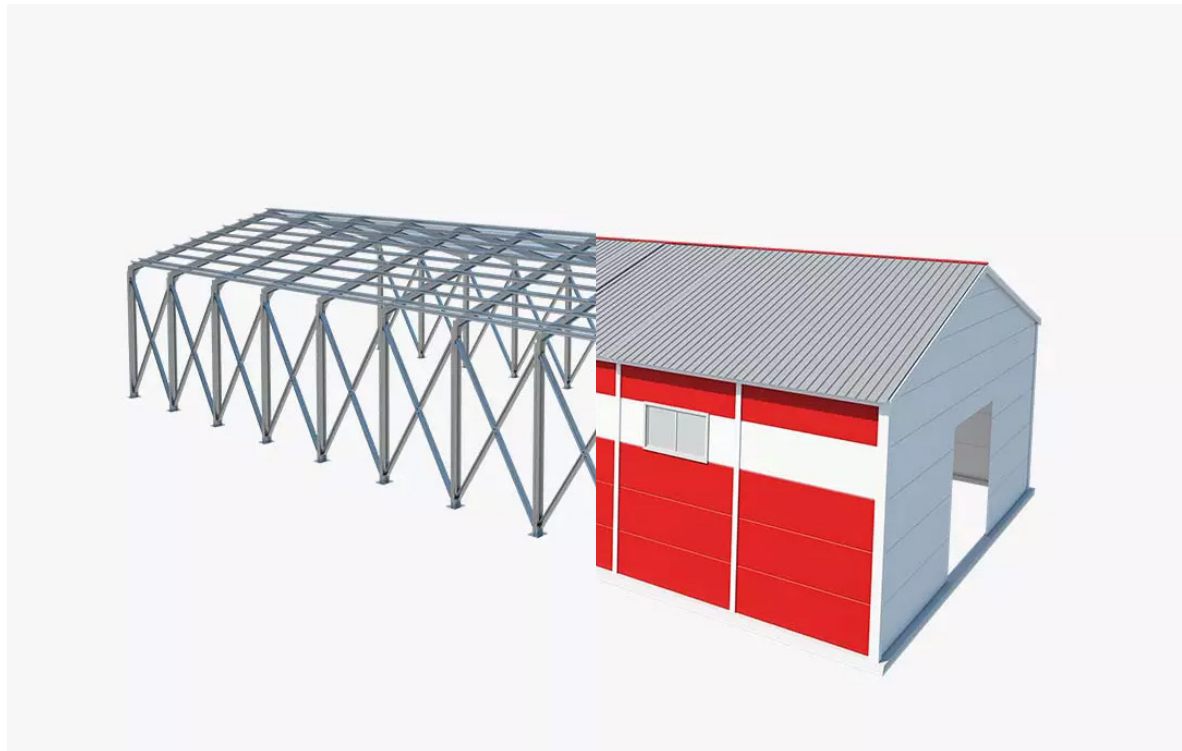

# Modular Buildings

LGS enables versatile and scalable modular construction, allowing for rapid assembly and reconfiguration to meet various project needs. Its lightweight yet strong structure provides high durability, while precision engineering ensures seamless integration of insulation, cladding, and utilities. Designed for efficiency and adaptability, LGS modular buildings offer cost-effective, sustainable, and long-lasting solutions for diverse applications.

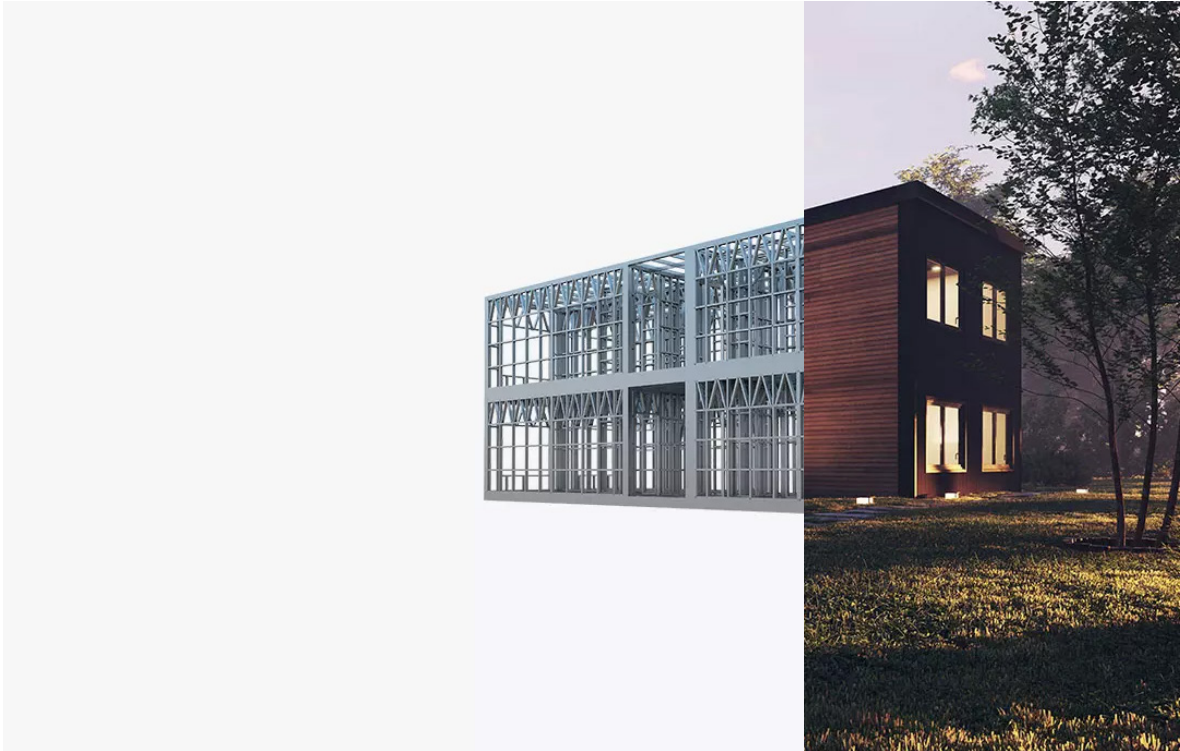

# Site Units

After natural disasters and humanitarian crises, LGS structures can be deployed quickly and efficiently. Their lightweight but durable nature makes them ideal for temporary shelters, field hospitals, and refugee housing, offering long-lasting, cost-effective solutions.



# Building Process in Photos





This project showcases the step-by-step construction of a single-storey residential home in Serbia, built using Light Gauge Steel (LGS) framing. From the initial foundation work to the final assembly, each stage highlights the efficiency, precision, and speed of LGS construction.

The prefabricated steel frame was manufactured off-site and assembled on-site in just a few days, significantly reducing labor time and material waste. With enhanced seismic resistance, thermal efficiency, and design flexibility, this home meets modern building standards while ensuring long-term durability.

---

Chapter

Contents:

Profiles & Frames

---

Contact Information

---

3

Info.

# Contact information

For media and press inquiries, collaboration requests, or brand-related information, please reach out to us. We are happy to provide press materials, interviews, and insights about DESSAU's innovative approach to modern construction and design.

## Address

Gubelstrasse 11  
6300 Zug  
Switzerland

Bulevar Kralja Petra I 89  
21000 Novi Sad  
Serbia

## Online

[sales@dessau.ch](mailto:sales@dessau.ch)  
[info@dessau.ch](mailto:info@dessau.ch)

[www.dessau.ch](http://www.dessau.ch)

## Sinisa Cegar

CPO



DESSAU Constructions GmbH

Thank you for your attention.

